

Features:

- Size 1/4" to 1/2" BSP
- Function 5 way 3 position lever
- Body Aluminium
- Pressure Range 0 to 10 BAR
- Media Air



Description:

The LEL53 series are a five way three position joystick control valve. The sprung center position has closed ports so no air can be put in or exhausted from the valve (will hold your cylinder in its last position). Ideal for controlling cylinders (allows you to 'creep' your cylinder forward or back and then hold it in one spot) or pneumatic actuators simply push the lever one way or the other. Simple to use, install and maintain.

Specification	LEL53-02	LEL53-03	LEL53-04
Port Size (BSPP)	1/4"	3/8"	1/2"
Exhaust Port Size	1/8"	1/4"	1/2"
Function	5/3 Lever Lever Closed Centres		
Pressure Range	0 to 10 BAR (147 psi)		
Max Inlet Pressure	10 BAR (147 psi)		
Medium Temperature	-5 to 60°C		
Body	Die Cast Aluminium		
End Caps	Reinforced Plastic		
Joystick	Thermoplastic		
Lubrication	Not Required		
Applicable Medium	Air		

5 Way 3 position Lever Lever Sprung Closed Centres

LEL53

Dimensions:

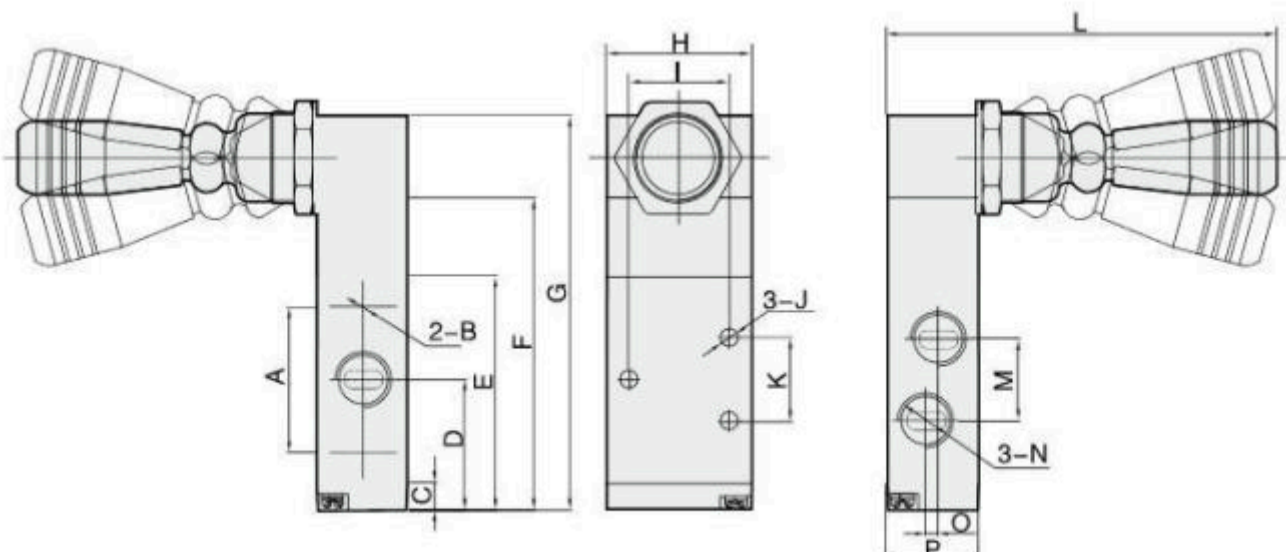

Features:

- Size 1/4" to 1/2" BSP
- Function 5 way 3 position lever
- Body Aluminium
- Pressure Range 0 to 10 BAR
- Media Air



Description:

The LEL53 series are a five way three position joystick control valve. The sprung center position has closed ports so no air can be put in or exhausted from the valve (will hold your cylinder in its last position). Ideal for controlling cylinders (allows you to 'creep' your cylinder forward or back and then hold it in one spot) or pneumatic actuators simply push the lever one way or the other. Simple to use, install and maintain.

Specification	LEL53-02	LEL53-03	LEL53-04
Port Size (BSPP)	1/4"	3/8"	1/2"
Exhaust Port Size	1/8"	1/4"	1/2"
Function	5/3 Lever Lever Closed Centres		
Pressure Range	0 to 10 BAR (147 psi)		
Max Inlet Pressure	10 BAR (147 psi)		
Medium Temperature	-5 to 60°C		
Body	Die Cast Aluminium		
End Caps	Reinforced Plastic		
Joystick	Thermoplastic		
Lubrication	Not Required		
Applicable Medium	Air		

5 Way 3 position Lever Lever Sprung Closed Centres

LEL53

Dimensions:

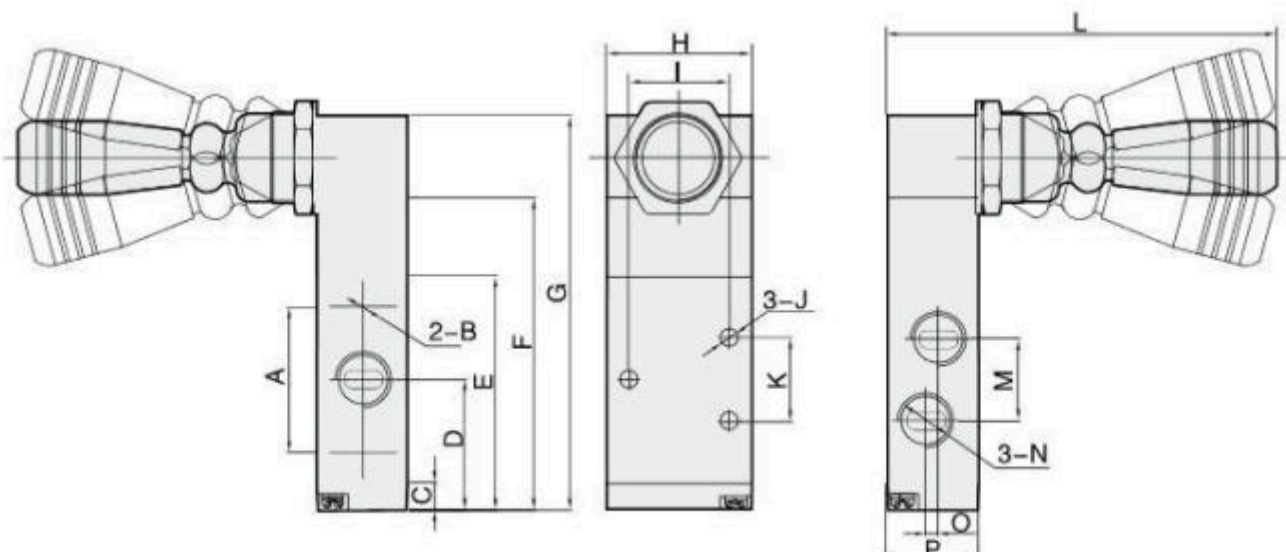

Features:

- Size 1/4" to 1/2" BSP
- Function 5 way 3 position lever
- Body Aluminium
- Pressure Range 0 to 10 BAR
- Media Air



Description:

The LEL53 series are a five way three position joystick control valve. The sprung center position has closed ports so no air can be put in or exhausted from the valve (will hold your cylinder in its last position). Ideal for controlling cylinders (allows you to 'creep' your cylinder forward or back and then hold it in one spot) or pneumatic actuators simply push the lever one way or the other. Simple to use, install and maintain.

Specification	LEL53-02	LEL53-03	LEL53-04
Port Size (BSPP)	1/4"	3/8"	1/2"
Exhaust Port Size	1/8"	1/4"	1/2"
Function	5/3 Lever Lever Closed Centres		
Pressure Range	0 to 10 BAR (147 psi)		
Max Inlet Pressure	10 BAR (147 psi)		
Medium Temperature	-5 to 60°C		
Body	Die Cast Aluminium		
End Caps	Reinforced Plastic		
Joystick	Thermoplastic		
Lubrication	Not Required		
Applicable Medium	Air		

5 Way 3 position Lever Lever Sprung Closed Centres

LEL53

Dimensions:

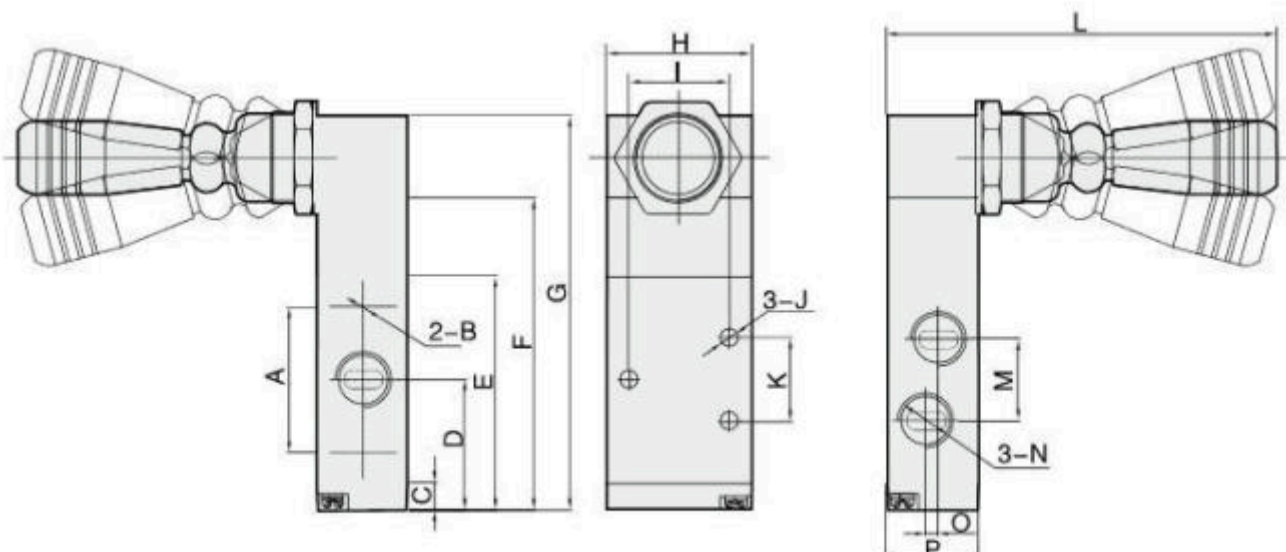



Features:

- Size 1/4" to 1/2" BSP
- Function 5 way 3 position lever
- Body Aluminium
- Pressure Range 0 to 10 BAR
- Media Air



Description:

The LEL53 series are a five way three position joystick control valve. The sprung center position has closed ports so no air can be put in or exhausted from the valve (will hold your cylinder in its last position). Ideal for controlling cylinders (allows you to 'creep' your cylinder forward or back and then hold it in one spot) or pneumatic actuators simply push the lever one way or the other. Simple to use, install and maintain.

Specification	LEL53-02	LEL53-03	LEL53-04
Port Size (BSPP)	1/4"	3/8"	1/2"
Exhaust Port Size	1/8"	1/4"	1/2"
Function	5/3 Lever Lever Closed Centres		
Pressure Range	0 to 10 BAR (147 psi)		
Max Inlet Pressure	10 BAR (147 psi)		
Medium Temperature	-5 to 60°C		
Body	Die Cast Aluminium		
End Caps	Reinforced Plastic		
Joystick	Thermoplastic		
Lubrication	Not Required		
Applicable Medium	Air		

5 Way 3 position Lever Lever Sprung Closed Centres

LEL53

Dimensions:

